



WHITNASH TOWN COUNCIL

Community Hall & Playing Field Risk Assessment

Site of Risk Assessment:	Community Hall and Playing Field at Acre Close in Whitnash, Warwickshire CV31 2ND	Assessment Date:	24/06/20	Report Date:	24/06/20
Assessment Carried Out By:	Simon Button AIIRSM	Signed:			
		Report Reference:	H&P / RA	2020 -	001
		Date Assessment to be Reviewed:	June 2023		

The Safety Officer of Whitnash Town Council (WTC) has carried out this general risk assessment of the Community Hall and Playing Field at Acre Close to control the risks to people who use the hall and field and are involved in the maintenance and upkeep.

WTC decided that there were sound legal and business reasons to record the findings of the risk assessment, and to take steps to make sure that they were brought to the attention of those working or holding an event in the hall or using the playing field.

The risk assessment was carried out by WTC's Health and Safety Officer, Simon Button AIIRSM.

WTC will ensure that the risk assessment will be made available to all workers doing jobs and all users of the hall or on the field. A copy was also put up in the reception and kitchen areas. The risk assessment will be reviewed as and when changes occur to the hall and playing fields, or how they are used.

The Community Hall and Playing Field are run as a community facility enabling local groups, of a diverse nature, to hire local facilities for their activities at reasonable rates.

The Hall & Playing Fields Committee are volunteers, who are all elected members of WTC.

There are two people who regularly work at Acre Close; the Handyman / Gardener Groundsman and the Caretaker / Cleaner.

It is part of the ethos of these facilities that users look after the facilities and clear up after themselves. They are also expected to respect our neighbours and other users and generally behave in a responsible manner. All occasional users are required to sign a booking form in which they acknowledge their acceptance of their responsibilities. All regular groups using the hall are invited and encouraged to send a representative attend the committee meetings so that they are aware of their responsibilities.

This risk assessment has been prepared to cover all aspects and areas of responsibility for the WTC Hall & Playing Fields Committee including:

- The hall including toilets, kitchen, bar area, , meeting rooms, storage areas and the stage
- The car park
- The sports field
- Children's play area
- In short everything.

Those who might be harmed are identified as:

1. Members of the public including especially vulnerable, children and individuals with disabilities
2. The Handyman / Gardener Groundsman
3. The Caretaker / Cleaner
4. WTC Representatives, Committee members & Volunteers
5. External Contractors

Whitnash Community Centre Acre Close, Whitnash

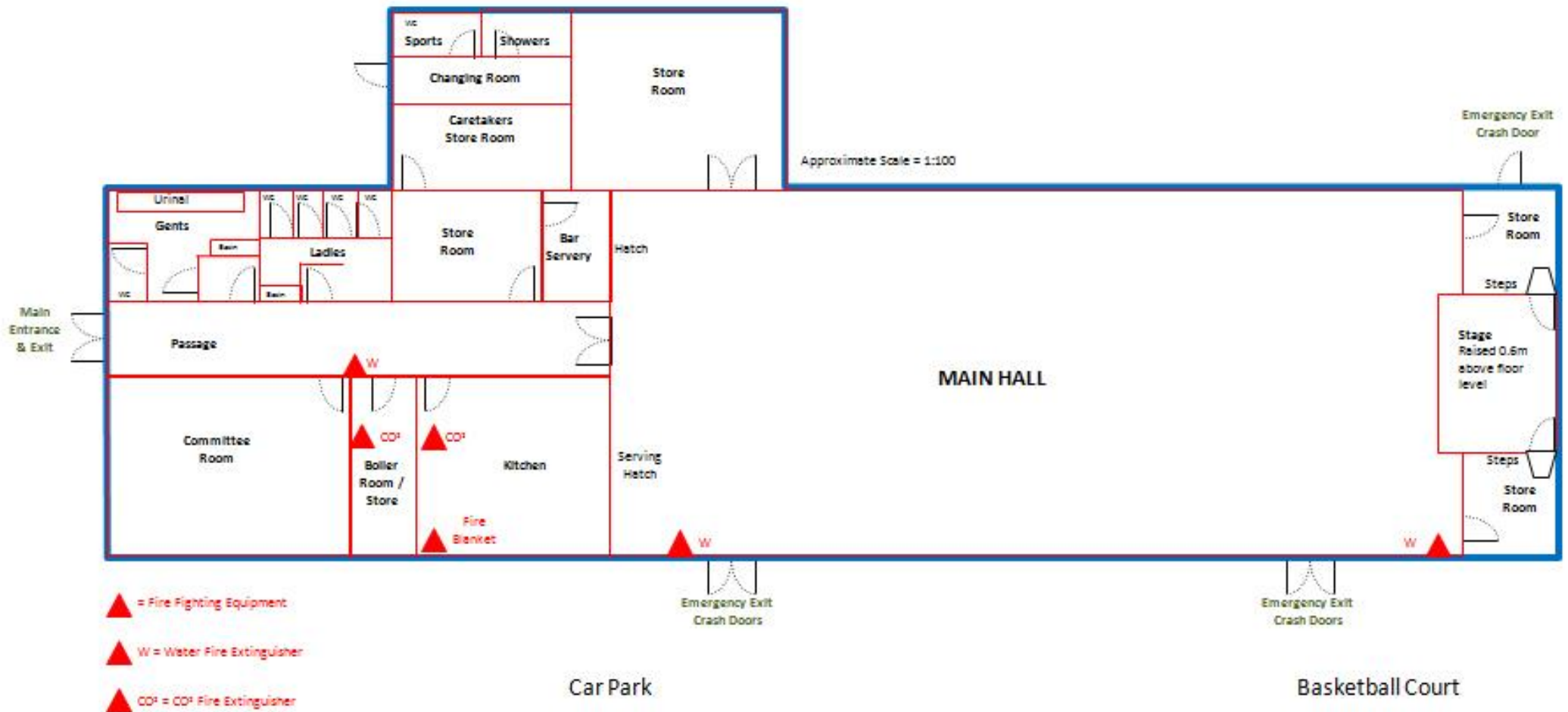

©Simon Button AllRSM 2011

Whitnash Town Council - Community Hall & Playing Field Risk Assessment - 2020

Definitions used in the assessment

Below we list all of the definitions or abbreviations used within the assessment:

WTC	=	Whitnash Town Council or nominated representatives.
Location or Activity	=	This is the area where the activity is taking place and a brief description of the activity.
Hazards & Likely Injuries	=	A brief description of the potential hazards and the potential injuries that could be sustained.
Persons in Danger	=	Any person who could be in danger in this area, as described on page 1.
Current Measures	=	The current measures that are in place to mitigate the likelihood of an injury being sustained.
Further Control Measures / Comment	=	Further actions required to reduce or control the risks & hazards to prevent injury. These will need to be "so far as is reasonably practicable".
Action by and when	=	This is who (person or organisation) would be expected to carry out the required actions and an expected date for these to be completed. This could be "N/A", if no actions are required.
Complete	=	The date that the required actions have been completed. This could be "N/A", if no actions are required.

Risk rating calculation

This risk assessment has been created using a simple Low – Medium - High calculation as follows:

Severity

Low	=	No injuries or slight injuries requiring first aid and minor ill health
Medium	=	Serious injuries or significant health effects
High	=	Death, or major injury (as per RIDDOR) or irreversible health damage

Likelihood

Low	=	No harm is anticipated, or harm will seldom occur
Medium	=	Harm will frequently occur
High	=	Certain or near certain harm will occur

Risk Rating (Rate) = Severity x Likelihood

Low	=	No actions required
Medium	=	Depending on severity, actions may be required
High	=	Corrective actions will be required

Urgency Rating of Corrective Actions

1	=	1 month
2	=	3 months
3	=	6 months
Other	=	State if there is any different timescale

Whitnash Town Council - Community Hall & Playing Field Risk Assessment - 2020

No	Location or Activity	Hazards & Likely Injuries	Persons in Danger	Current Measures	Severity H/M/L	Likelihood H/M/L	Rate H/M/L	Further Control Measures / Comment	Action by and when	Complete
1.	Hall & Playing Fields Entry / Exit	Pedestrians could suffer serious injury if struck by cars entering/leaving the playing field	Any person entering / leaving the site	The area is in general open to the public and difficult to control, however this area is locked out of hours. This is single track and there is a pedestrian gate	H	L	M	No further action required as no further reasonable control measures can be taken	N/A	N/A
2.	Hall & Playing Fields Driveway	Pedestrians could suffer serious injury if struck by cars	Any person on the site	This is single track and is clearly segregated from the field area. There are speed bumps to reduce the speed of cars	H	L	M	No further action required as no further reasonable control measures can be taken	N/A	N/A
3.	Hall & Playing Fields Car Park	Pedestrians could suffer serious injury if struck by cars entering/leaving car park or moving in it. Vehicles colliding with other road users while entering or leaving the car park	Any person on the site	Car park is well lit and well surfaced and thus drivers are not distracted by poor surface issues such as pot-holes. Cars entering and leaving the car park are restricted in speed terms by the design of the gate and the single track road. Users of hall are aware through hire agreement to consider whether they need to control car parking	H	L	M	No further action required as no further reasonable control measures can be taken. Surface to be inspected regularly and repaired as necessary	N/A	N/A
4.	Hall & Playing Fields Car Park	Slips, trips and falls Users of the hall may suffer injuries such as fractures or bruising if they slip or trip over objects or in pot holes	Any person on the site	Car park is well lit and well surfaced and therefore there are no issues such as pot-holes	L	L	L	No further action required as no further reasonable control measures can be taken	N/A	N/A
5.	Hall - Security	Risks to intruders who break in to the hall	Any person on the site	The hall is locked and alarmed, with safety windows and secure shutters on the outside. We have CCTV in place and regular Police patrols.	M	L	M	No further action required. Continue with CCTV monitoring and Police patrols, but otherwise no further reasonable control measures can be taken	N/A	N/A
6.	Hall & Playing Fields Wet & Windy Weather Extremes	Persons being struck by debris caused by high winds and rain	Any person on the site	The hall is regularly maintained to ensure that it is in a safe condition. Users of the hall can cancel their activities if necessary in dangerous conditions	H	L	M	No further action required as no further reasonable control measures can be taken as this is an exception and would not reasonably be expected	N/A	N/A

Whitnash Town Council - Community Hall & Playing Field Risk Assessment - 2020

No	Location or Activity	Hazards & Likely Injuries	Persons in Danger	Current Measures	Severity H/M/L	Likelihood H/M/L	Rate H/M/L	Further Control Measures / Comment	Action by and when	Complete
7.	Hall & Playing Fields - Cold Weather Extremes	Slips, trips and falls in icy conditions. Persons being struck by falling ice	Any person on the site	It is the responsibility of users to review the conditions and, if necessary, bookings can be cancelled. The hall has central heating which copes with normal winter cold spells	M	L	M	No further action required as no further reasonable control measures can be taken as this is an exception and would not reasonably be expected	N/A	N/A
8.	Hall & Playing Fields - Vandalism	Persons being injured as a result of areas being vandalised	Any person on the site	The area is in general open to the public and difficult to secure. It is an area where children and youngsters gather to play. Inevitably, though regrettably, we suffer from vandalism at times. We have CCTV in place and regular Police patrols. We always attempt to repair any damage and clean graffiti or mess as soon as possible	M	L	M	No further action required. Continue with CCTV monitoring and Police patrols, but otherwise no further reasonable control measures can be taken	N/A	N/A
9.	Hall & Playing Fields - Maintenance	Anyone working at any height could suffer injuries, possibly very serious ones, should they fall	Persons carrying out maintenance	The handyman knows how to use a stepladder safely. A safe procedure has been produced and issued to the handyman.	M	L	M	No further reasonable control measures can be taken	N/A	N/A
10.	Hall & Playing Fields - Lone Working	Persons could suffer serious injury if the slip, trip or fall, or if they are attacked whilst working alone	Handyman Gardener, Caretaker / Cleaner or WTC Employees	Lone working is not advised. The persons listed to the left are the only people who regularly work on their own in the hall or playing fields. A safe procedure has been produced and has been issued.	M	L	M	It would be advisable for Lone worker training to be provided. Otherwise no further reasonable control measures can be taken.	SB to liaise with the Town Clerk	
11.	Hall - Entry / Exit	Slips, trips and falls Users of the hall may suffer injuries such as fractures or bruising if they slip on spillages or trip over objects	Any person entering / exiting or in the hall	Doorways are clearly positioned & lighting, including emergency lighting, provided. Obstructions are not allowed to block access routes. Floors are well surfaced & free from obvious trip danger	L	L	L	No further action required. Mats at entrances to stop rain water being carried in. Surface to be inspected regularly and repaired as necessary	N/A	N/A

Whitnash Town Council - Community Hall & Playing Field Risk Assessment - 2020

No	Location or Activity	Hazards & Likely Injuries	Persons in Danger	Current Measures	Severity H/M/L	Likelihood H/M/L	Rate H/M/L	Further Control Measures / Comment	Action by and when	Complete
12.	Hall - Disabled Entry / Exit	Slips, trips and falls Users of the hall may suffer injuries such as fractures or bruising if they slip on spillages or trip over objects	Disabled persons entering / exiting or in the hall	Doorways are clearly positioned & lighting, including emergency lighting, provided. Obstructions are not allowed to block access routes. Floors are well surfaced & free from obvious trip danger. A disabled ramp is installed at the front entrance and other entrances are disabled friendly.	L	L	L	No further action required. Mats at entrances to stop rain water being carried in. Surface to be inspected regularly and repaired as necessary	N/A	N/A
13.	Hall - Emergency Exits	Crush, slips, trips and falls. Users of the hall may suffer injuries such as fractures or bruising if they slip on spillages or trip over objects	Any person in the hall	The hall has 4 exits. The main entrance/exit door is always open whilst the hall is in use. There are two double crash doors on the right hand side and one at the far end on the left hand side. Doorways are clearly positioned & lighting, including emergency lighting, provided. Obstructions are not allowed to block access routes. Floors by the exits are well surfaced and free from any obvious trip danger. Users know (through hire agreement) to clear up spillages immediately & know where equipment for this is kept. No storage in corridors & no trailing electrical leads/cables.	M	L	L	No further action required. Surface to be inspected regularly and repaired as necessary.	N/A	N/A
14.	Hall - Fire	If trapped, persons could suffer fatal injuries from smoke inhalation / burns	Any person in the hall	The hall is a no smoking area and appropriately signed. Emergency exits, clearly marked are included in the building design. The illuminated exit signs are inspected as part of the electrical inspection and the fire inspection. A Fire risk assessment has been undertaken	H	L	M	No further action required as no further reasonable control measures can be taken	N/A	N/A

Whitnash Town Council - Community Hall & Playing Field Risk Assessment - 2020

No	Location or Activity	Hazards & Likely Injuries	Persons in Danger	Current Measures	Severity H/M/L	Likelihood H/M/L	Rate H/M/L	Further Control Measures / Comment	Action by and when	Complete
15.	Hall - Asbestos	Asbestos only poses a risk if fibres are released into air and inhaled. Maintenance workers are most at risk	Staff, and others, carrying out normal activities	Asbestos Surveys have been carried and remedial measures have been implemented. A safe procedure has been produced and issued to the Caretaker. An annual Asbestos Maintenance check carried out annually.	H	L	M	No further action required as no further reasonable control measures can be taken, as the asbestos is managed. If the hall is demolished / refurbished, asbestos must be removed by specialist contractors.	N/A	N/A
16.	Hall - First Aid	If there is first aid provision in the hall, but any person working in or using the hall could suffer further complications to any injuries sustained	Any person in the hall	During WTC meetings, there are first aiders on the Council. Users know (through hire agreement) to use the hall at their own risk for private functions etc	M	L	L	No further action required as no further reasonable control measures can be taken	N/A	N/A
17.	Hall - Passage	Slips, trips and falls. E.g. uneven surface of floors and cleaning floors etc. Users of the hall may suffer injuries such as fractures or bruising if they slip on spillages or trip over objects	Any person in the hall	Users know (through hire agreement) to clear up spillages immediately and know where equipment for this is kept. Mats at entrances to stop rain water being carried in. No storage in corridors & no trailing electrical leads/cables	L	L	L	No further action required as no further reasonable control measures can be taken. Surface to be inspected regularly and repaired as necessary.	N/A	N/A
18.	Hall - Toilets	Slips, trips and falls from wet floors etc. Users of the toilets may suffer injuries such as fractures or bruising.	Any person using the toilets	Obstructions are not allowed to block access routes. Floors are well surfaced and free from any obvious trip danger	L	L	L	No further action required as no further reasonable control measures can be taken	N/A	N/A
19.	Hall - Heating System	Possibility of fire / explosion causing burns or death or carbon monoxide poisoning causing asphyxiation	Any person in the hall	All gas installations are installed, maintained and inspected annually by GAS SAFE registered contractors	H	L	M	No further action required as no further reasonable control measures can be taken. Boiler to be inspected annually and repaired as necessary.	N/A	N/A

Whitnash Town Council - Community Hall & Playing Field Risk Assessment - 2020

No	Location or Activity	Hazards & Likely Injuries	Persons in Danger	Current Measures	Severity H/M/L	Likelihood H/M/L	Rate H/M/L	Further Control Measures / Comment	Action by and when	Complete
20.	Hall - Electricity	Maintenance personnel or hall users risk electric shocks or burns from faulty equipment or installation	Any person in the hall, especially those carrying out maintenance activities.	The electrical installation, including appropriate trip switches and RCD safety devices are inspected on a regular basis in accordance with the regulations and licensing requirements. Portable appliance testing is carried out on an annual basis where necessary. Fixed installation correctly installed by qualified electrician, and inspected regularly. All repairs by qualified electrician. Safety plugs in sockets. Portable equipment checked for visual signs of damage before use. Hall users know they are responsible for any equipment used on site.	M	L	M	Make sure hall users know where the fuse box is and how to switch supply off in an emergency. Remind users that portable equipment considered unsafe should be marked and taken out of use	N/A	N/A
21.	Hall - Meeting Room	Slips, trips and falls. Users of the room may suffer injuries such as fractures or bruising if they slip.	Any person using the meeting room	Obstructions are not allowed to block access routes. Floors are well surfaced and free from any obvious trip danger	L	L	L	No further action required as no further reasonable control measures can be taken	N/A	N/A
22.	Hall - Hazardous substances E.g. cleaning products (COSHH)	The cleaner, and others cleaning, risk skin problems, eg dermatitis and eye damage, from direct contact with cleaning chemicals. Vapour may cause breathing problems	The Caretaker / Cleaner	If hazardous substances are left out and available to all users, there is a risk of misuse and/or mistakes which could be hazardous. Instructions are given to all regular users that any such material must be kept locked up out of sight in cupboards. The cleaner is reminded to check for dry, red or itchy skin on the hands and, if finding any, to go to doctors for advice and to inform the WTC office	L	L	L	No further action required as no further reasonable control measures can be taken.	N/A	N/A

Whitnash Town Council - Community Hall & Playing Field Risk Assessment - 2020

No	Location or Activity	Hazards & Likely Injuries	Persons in Danger	Current Measures	Severity H/M/L	Likelihood H/M/L	Rate H/M/L	Further Control Measures / Comment	Action by and when	Complete
23.	Hall - Bar Area	Slips, trips and falls from wet floors etc	Any person using the bar area	Users know (through hire agreement) to clear up spillages immediately and are informed where cleaning equipment for this is kept.	M	L	L	No further action required as no further reasonable control measures can be taken	N/A	N/A
24.	Hall - Bar Area Glasses	Cuts from broken glasses	Any person using the bar area	Users know (through hire agreement) to use the hall at their own risk for private functions etc	M	L	L	No further action required as no further reasonable control measures can be taken	N/A	N/A
25.	Hall - Kitchen General	Slips, trips and falls. E.g. uneven surface of floors and cleaning floors etc. Users of the hall may suffer injuries such as fractures or bruising if they slip on spillages or trip over objects	Any person using the Kitchen	The floor in the kitchen is in good condition & is inspected regularly. There is good lighting. Users know (through hire agreement) to clear up spillages immediately and are informed where cleaning equipment for this is kept.	M	L	L	No further action required as no further reasonable control measures can be taken.	N/A	N/A
26.	Hall - Kitchen Appliances	Cuts, bruises and burns.	Any person using the Kitchen	Users know (through hire agreement) to use all equipment in a sensible manner.	M	L	L	No further action required as no further reasonable control measures can be taken	N/A	N/A
27.	Hall - Kitchen Utensils	Cuts from sharp objects and burns from heated objects and boiling water.	Any person using the Kitchen	Users know (through hire agreement) to use all equipment in a sensible manner.	M	L	L	No further action required as no further reasonable control measures can be taken	N/A	N/A
28.	Hall - Kitchen Food Hygiene	Food Poisoning.	Any person using the Kitchen	The premises include kitchens which comply with the food hygiene regulations as applied by the local authority. Users are advised by the admin assistant to ensure any caterers they use are licensed.	L	L	L	No further action required as no further reasonable control measures can be taken	N/A	N/A

Whitnash Town Council - Community Hall & Playing Field Risk Assessment - 2020

No	Location or Activity	Hazards & Likely Injuries	Persons in Danger	Current Measures	Severity H/M/L	Likelihood H/M/L	Rate H/M/L	Further Control Measures / Comment	Action by and when	Complete
29.	Hall - Kitchen / Hall Hazardous substances E.g. cleaning products (COSHH)	The cleaner, and others cleaning, risk skin problems, eg dermatitis and eye damage, from direct contact with cleaning chemicals. Vapour may cause breathing problems	The Caretaker / Cleaner or any person using the Kitchen	If cleaning liquids and bleaches are left out available to all and any user then there is a risk of misuse and/or mistakes which could be hazardous. Instructions are given to all regular hall users that any such material must be kept locked up and out of sight in cupboards. The cleaner is reminded to check for dry, red or itchy skin on the hands and, if finding any, to go to doctors for advice and to inform the WTC office	L	L	L	No further action required as no further reasonable control measures can be taken.	N/A	N/A
30.	Hall - Manual Handling	Users may suffer back pain if they try to lift objects that are too heavy or awkward	Any person working at or using the Hall	Users know that they must stack tables and chairs carefully so that they do not collapse	L	L	L	No further action required as no further reasonable control measures can be taken	N/A	N/A
31.	Hall - Working at Height	Anyone working at any height could suffer injuries, possibly very serious ones, should they fall	Any person working at or using the Hall	Hall users are responsible for bringing their own steps etc. and for using them safely. There are no facilities provide by WTC.	L	L	L	No further action required as no further reasonable control measures can be taken	N/A	N/A
32.	Hall - Storage Areas Stacking of objects	Users could suffer injuries by poorly stacked object falling on them or by collapsing shelving	Any person using these areas	These areas are properly maintained and users know (through hire agreement) to use the hall at their own risk for private functions etc	M	L	L	No further action required as no further reasonable control measures can be taken	N/A	N/A
33.	Hall - Storage Areas Manual Handling	Users may suffer back pain if they try to lift objects that are too heavy or awkward	Any person moving objects in these areas	Many regular users of the hall store equipment for their activities at the hall. Users are expected to be sensible in the way they store / handle heavy or awkward objects.	M	L	L	No further action required as no further reasonable control measures can be taken	N/A	N/A

Whitnash Town Council - Community Hall & Playing Field Risk Assessment - 2020

No	Location or Activity	Hazards & Likely Injuries	Persons in Danger	Current Measures	Severity H/M/L	Likelihood H/M/L	Rate H/M/L	Further Control Measures / Comment	Action by and when	Complete
34.	Hall - General Use	Slips, trips and falls. E.g. uneven surface & floor cleaning etc. Hall users may suffer injuries (fractures, bruising etc, if they slip on spillages or trip over objects	Any person using the Hall	The hall is purpose built and well maintained for the varied activities. All users are expected to use the facilities responsibly and report any problems or damage to WTC. The Council has a policy of repairing or correcting faults as speedily as is possible. Good lighting in all rooms and corridors in hall. Users know (through hire agreement) to clear up spillages immediately and are informed where cleaning equipment for this is kept. No storage in corridors & no trailing electrical leads/cables. All providers of services / entertainment are required to have their own Insurance	L	L	L	No further action required as no further reasonable control measures can be taken	N/A	N/A
35.	Hall - Special Events	Slips, trips and falls. E.g. uneven surface & floor cleaning etc. Hall users may suffer injuries (fractures, bruising etc, if they slip on spillages or trip over objects	Any person using the Hall	Special events are organised from time to time. All events are considered carefully and risks realised and minimised. All providers of services / entertainment are required to have their own Insurance	L	L	L	No further action required as no further reasonable control measures can be taken	N/A	N/A
36.	Hall - Stage	Slips, trips and falls. E.g. uneven surface & floor cleaning etc. Hall users may suffer injuries (fractures, bruising etc, if they slip on spillages or trip over objects	Any person using the Stage	Floors are well surfaced and free from any obvious trip danger. All providers of services / entertainment are required to have their own Insurance	L	L	L	No further action required as no further reasonable control measures can be taken	N/A	N/A

Whitnash Town Council - Community Hall & Playing Field Risk Assessment - 2020

No	Location or Activity	Hazards & Likely Injuries	Persons in Danger	Current Measures	Severity H/M/L	Likelihood H/M/L	Rate H/M/L	Further Control Measures / Comment	Action by and when	Complete
37.	Hall - Noise	Hearing problems from excessive noise	Any person using the Hall	Users hiring the hall are made aware of the conditions of hire, one of which requires consideration for our neighbours in the level of noise. Users for discos or parties are expected to be aware of their responsibilities for their activities. All providers of services / entertainment are required to have their own Insurance	L	L	L	No further action required as no further reasonable control measures can be taken	N/A	N/A
38.	Hall - Changing Rooms	Slips, trips and falls. E.g. uneven surface & floor cleaning etc. Hall users may suffer injuries (fractures, bruising etc, if they slip on spillages or trip over objects	Any person using the Changing Rooms or cleaning them	Users hiring the hall are made aware of the conditions of hire and they use the changing rooms at their own risk. Good lighting in all rooms and corridors in hall. Users know (through hire agreement) to clear up spillages immediately and know where equipment for this is kept.	L	L	L	No further action required as no further reasonable control measures can be taken. No storage in corridors.	N/A	N/A
39.	Youth Shelter - Using the shelter	Slips, trips and falls	Any person using the youth shelter	All persons are aware that they use the facilities at their own risk. The shelter is routinely overviewed by WTC and any problems dealt with on an ad-hoc basis	L	L	L	No further action required as no further reasonable control measures can be taken	N/A	N/A
40.	Youth Shelter - Passing the shelter	Hit by snow or ice falling from the roof	Any person passing the youth shelter	No occurrence of such an accident is known to have happened.	M	L	L	No further action required as no further reasonable control measures can be taken as this is an exception and not reasonably expected	N/A	N/A
41.	Basket Ball Court - Use of the Court	Slips, trips and falls	Any person using the court	All persons are aware that they use the facilities at their own risk. The court is routinely overviewed by WTC and any problems dealt with on an ad-hoc basis	M	L	L	No further action required as no further reasonable control measures can be taken	N/A	N/A

Whitnash Town Council - Community Hall & Playing Field Risk Assessment - 2020

No	Location or Activity	Hazards & Likely Injuries	Persons in Danger	Current Measures	Severity H/M/L	Likelihood H/M/L	Rate H/M/L	Further Control Measures / Comment	Action by and when	Complete
42.	Ramp - Use of the Ramp	Slips, trips and falls	Any person using the ramp	All persons are aware that they use the facilities at their own risk. The ramp is routinely overviewed by WTC and any problems dealt with on an ad-hoc basis	M	L	L	No further action required as no further reasonable control measures can be taken	N/A	N/A
43.	Children's Play Area and exercise equipment - Use of the Play Area and exercise equipment	Slips, trips and falls Users of the playground may suffer injuries such as fractures or bruising if they fall or slip, or trip on uneven surface or pot holes	Children & adults in the area & using the equipment	All persons are aware that they use the facilities at their own risk. The play area is a purpose built exterior facility for children. Responsibility for maintenance rests with WTC. WTC has a representative who routinely inspects the area and liaises with the WTC office. WTC has a Grounds Maintenance Contractor. Any problems are dealt with. The equipment is inspected on an annual basis by ROSPA.	M	L	L	No further action required as no further reasonable control measures can be taken.	N/A	N/A
44.	Children's Play Area and exercise equipment - Use of the Play Area and exercise equipment	Cuts from broken glass on the floor	Children & adults in the area & using the equipment	All persons are aware that they use the facilities at their own risk. The play area is a purpose built exterior facility for children. Responsibility for maintenance rests with WTC. WTC has a representative who routinely inspects the area and liaises with the WTC office. WTC has a Grounds Maintenance Contractor. Any problems are dealt with. The equipment is inspected on an annual basis by ROSPA.	M	L	L	No further action required as no further reasonable control measures can be taken. As the equipment is inspected by ROSA, WTC will always act upon any recommendations made following inspections.	N/A	N/A

Whitnash Town Council - Community Hall & Playing Field Risk Assessment - 2020

No	Location or Activity	Hazards & Likely Injuries	Persons in Danger	Current Measures	Severity H/M/L	Likelihood H/M/L	Rate H/M/L	Further Control Measures / Comment	Action by and when	Complete
45.	Children's Play Area and exercise equipment - Use of the Play Area and exercise equipment	Dog Fouling – Diseases such as Campylobacter	Children & adults in the area & using the equipment	All persons are aware that they use the facilities at their own risk. The field and surrounding area is frequently used by dog walkers, who are aware of their responsibility to remove faeces. Appropriate bins & signs are provided. WTC has a representative who routinely inspects the area and liaises with the WTC office.	M	L	L	No further action required as no further reasonable control measures can be taken.	N/A	N/A
46.	Playing Field - Using the field	Slips, trips and falls	Any person in the field area or using it for sports activities	All persons are aware that they use the facilities at their own risk. Responsibility for maintenance rests with WTC. WTC has a representative who routinely inspects the area and liaises with the WTC office. WTC has a Grounds Maintenance Contractor. Any problems are dealt with.	M	L	L	No further action required as no further reasonable control measures can be taken.	N/A	N/A
47.	Playing Field - Using the field	Cuts from broken glass on the floor	Any person in the field area or using it for sports activities	All persons are aware that they use the facilities at their own risk. Responsibility for maintenance rests with WTC. WTC has a representative who routinely inspects the area and liaises with the WTC office. WTC has a Grounds Maintenance Contractor. Any problems are dealt with.	M	L	L	No further action required as no further reasonable control measures can be taken.	N/A	N/A

Whitnash Town Council - Community Hall & Playing Field Risk Assessment - 2020

No	Location or Activity	Hazards & Likely Injuries	Persons in Danger	Current Measures	Severity H/M/L	Likelihood H/M/L	Rate H/M/L	Further Control Measures / Comment	Action by and when	Complete
48.	Playing Field - Using the field	Dog Fouling – Diseases such as Campylobacter	Any person in the field area or using it for sports activities	All persons are aware that they use the facilities at their own risk. The field and surrounding area is frequently used by dog walkers, who are aware of their responsibility to remove faeces. Appropriate bins & signs are provided. WTC has a representative who routinely inspects the area and liaises with the WTC office.	M	L	L	No further action required as no further reasonable control measures can be taken by Whitnash Town Council, as they have no powers to implement any actions against owners who do not clean up after their dogs.	N/A	N/A
49.	Playing Field - Using the field	Flooding, causing slips, trips and falls	Any person in the field area or using it for sports activities	All persons are aware that they use the facilities at their own risk. Responsibility for maintenance rests with WTC. WTC has a representative who routinely inspects the area and liaises with the WTC office. WTC has a Grounds Maintenance Contractor. Any problems are dealt with.	M	L	L	No further action required as no further reasonable control measures can be taken.	N/A	N/A
50.	Playing Field - Using the field Football Matches	Slips, trips and falls	Any person in the field area or using it for sports activities	Whitnash Town Football Club organise regular league games on the playing field in accordance with club / league rules. Trained and approved referees are used. All referees are trained in first aid. In addition every team has at least one member trained in first aid. Other activities are purely ad hoc occasions when groups gather to play together. The field is a normally open facility. Whitnash Sports & Social Club maintains the pitches and the WTC's Grass Cutting Contractor mows the field, including the pitches, but WS&SC cut & mark the pitches.	M	L	L	No further action required as no further reasonable control measures can be taken.	N/A	N/A

Whitnash Town Council - Community Hall & Playing Field Risk Assessment - 2020

No	Location or Activity	Hazards & Likely Injuries	Persons in Danger	Current Measures	Severity H/M/L	Likelihood H/M/L	Rate H/M/L	Further Control Measures / Comment	Action by and when	Complete
51.	Playing Field - Pathways and the Measured Mile	Slips, trips and falls	Any person using the pathways and the Measured Mile	All persons are aware that they use the facilities at their own risk. Responsibility for maintenance rests with WTC. WTC has a representative who routinely inspects the area and liaises with the WTC office. WTC has a Grounds Maintenance Contractor. Any problems are dealt with.	M	L	L	No further action required as no further reasonable control measures can be taken.	N/A	N/A
52.	Playing Field - Pathways and the Measured Mile	Cuts from broken glass on the floor	Any person using the pathways and the Measured Mile	All persons are aware that they use the facilities at their own risk. Responsibility for maintenance rests with WTC. WTC has a representative who routinely inspects the area and liaises with the WTC office. WTC has a Grounds Maintenance Contractor. Any problems are dealt with.	M	L	L	No further action required as no further reasonable control measures can be taken.	N/A	N/A
53.	Playing Field - Pathways and the Measured Mile	Dog Fouling – Diseases such as Campylobacter	Any person using the pathways and the Measured Mile	All persons are aware that they use the facilities at their own risk. The field and surrounding area is frequently used by dog walkers, who are aware of their responsibility to remove faeces. Appropriate bins & signs are provided. WTC has a representative who routinely inspects the area and liaises with the WTC office.	M	L	L	No further action required as no further reasonable control measures can be taken.	N/A	N/A

Whitnash Town Council - Community Hall & Playing Field Risk Assessment - 2020

Recommendations / Action Items

It is noted that a number of "Medium" ratings are based on the severity being high. It is further noted that owing to the current control measures the likelihood is minimal, therefore no further action is required in these cases. See below for the definition.

Risk Rating (Rate) = Severity x Likelihood

- Low** = No actions required
- Medium** = Depending on severity, actions may be required
- High** = Corrective actions will be required

Urgency Rating

- 1** = 1 month
- 2** = 3 months
- 3** = 6 months
- Other** = State

<u>NO</u>	<u>RA NO</u>	<u>PAGE</u>	<u>AREA</u>	<u>DETAILS</u>	<u>URGENCY</u>
1.	10	5	H&PF - Lone Working	It is advisable for lone worker training to be provided. This was previously raised, but no action was taken, as the caretaker left. It may be worth considering in the future. It is not currently an issue, as the hall is closed owing to COVID-19	3

CORRECTIVE ACTIONS

<u>NO</u>	<u>DETAILS</u>	<u>ACTION BY</u>	<u>DATE</u>
1.			